

**IMPORTANT LIFE SAFETY NOTE**  
 NOTE 2 BARRIERS REQUIRED.  
 MINIMUM WALL DEPTH REQUIRED FOR RATING:  
 8.625" (219mm) FOR SINGLE SIDE INSTALLATION (SHOWN)  
 8.625" (219mm) FOR DUAL SIDE INSTALLATION  
 ARCHITECT / CONTRACTOR MUST VERIFY PRIOR TO FABRICATION

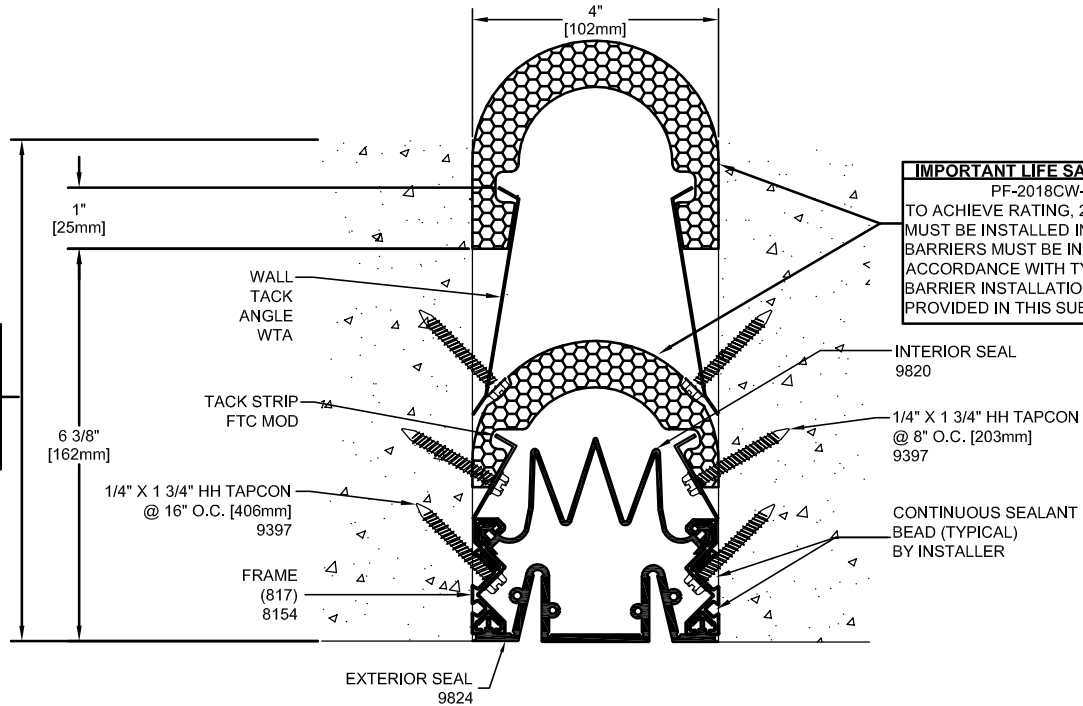

**IMPORTANT LIFE SAFETY PRODUCT NOTE**  
 PF-2018CW-SC-4-2  
 TO ACHIEVE RATING, 2-HOUR FIRE BARRIER MUST BE INSTALLED IN 2-HOUR RATED WALL. BARRIERS MUST BE INSTALLED IN STRICT ACCORDANCE WITH TYPICAL WALL FIRE BARRIER INSTALLATION INSTRUCTIONS PROVIDED IN THIS SUBMITTAL.

Model	Nominal "JT"	Joint Opening "JT"				Total Movement	Mat. Code
		Seismic Min.	Thermal Min.	Thermal Max.	Seismic Max.		
VSS-400-E_CONC_2HWPF_SS	4" (102)	1.75" (44)	3" (76)	6" (152)	10" (254)	8.25" (210)	VS1403

\* NOTE THAT EXTERIOR SEAL WILL DISENGAGE AT 6.5" BUT INTERIOR SEAL WILL STAY INTACT.  
 ( ) IN MOVEMENT TABLE DENOTES mm IN METRIC.

**ARCHITECT/CONTRACTOR NOTE:**  
 ALL SUBASSEMBLY COMPONENTS TO BE PROVIDED IN 10'-0" OR 20'-0" STOCK LENGTHS UNLESS OTHERWISE NOTED. THE SPECIFIC SYSTEMS DICTATE THE LENGTHS PROVIDED.

Approved by: \_\_\_\_\_ Date: \_\_\_\_\_  
**SEAL NOTE: SPECIFY SEAL COLOR**  
 STANDARD COLORS:  
 CARBON (BLACK)       PRAIRIE (BEIGE)  
 FOG (GRAY)             LUNAR (WHITE)  
\*CUSTOM COLOR AVAILABLE IN MINIMUM QUANTITIES 100 LF. CONTACT MM FOR PRICING & AVAILABILITY.

Representative:	Customer:	Project:	Location:	Project Number:
-----------------	-----------	----------	-----------	-----------------



**MM SYSTEMS**  
 50 MM WAY  
 PENDERGRASS, GA. 30567  
 PHONE: 706-824-7500  
 800-241-3460  
 FAX: 706-824-7501  
[www.mmsystemscorp.com](http://www.mmsystemscorp.com)  
 For Spec-Data, Installation Guides, or movement requirements, contact MMSC

**RIGHTS OF DESIGN**  
 All rights of design, detail, engineering and/or invention contained herein are the property of MM Systems Corporation and hereby reserved and are not to be reproduced or provided to any other party. MM Systems Corporation reserves the right to amend or withdraw any information contained herein without notice and will not be liable for any inaccuracy or ambiguity of said information.

**VSS-400-E\_CONC\_2HWPF\_SS**  
 Model:  
 Drawn by: LMP  
 Scale: NTS  
 Issue Date: 08-23-11  
 Drawing Number: **VS1403**  
 SHT. . OF .